

ACCESSORIES AVAILABLE
ACCESORIOS DISPONIBLES
ACCESSOIRES DISPONIBLES

BC601	4 oz. Bostitch Air-Tool Lubricant
BC602	1 pint Bostitch Air-Tool Lubricant
BC603	1 pint Bostitch "Winter-Formula" Air-Tool Lubricant
BC604	1 quart Bostitch Air-Tool Lubricant
851385	Loctite Grade 242 (.02 oz.)
N80K2	Remote control kit
N89ORK	Kit, O-ring repair
171343	Shield, Dust, N89C
1134B-0864701	Plug, Dust Shield

BOSTITCH®

N89C

COIL-FED PNEUMATIC FRAMING NAILER
CLAVADORA NEUMÁTICA ALIMENTADA POR ROLLO
CLOUEUR PNEUMATIQUE À ENROULEMENT



TOOL PARTS ILLUSTRATION
ILUSTRACIÓN DE LAS PIEZAS DE LA HERRAMIENTA
ILLUSTRATION DES PIÈCES D'OUTILLAGE

⚠WARNING:

⚠ADVERTENCIA:

⚠ATTENTION:

BEFORE PERFORMING REPAIRS ON THIS TOOL, ALL OPERATORS SHOULD STUDY THIS ILLUSTRATION, AS WELL AS THE PARTS LIST AND OPERATION AND MAINTENANCE MANUAL. OPERATORS SHOULD UNDERSTAND AND FOLLOW ALL SAFETY WARNINGS AND INSTRUCTIONS. KEEP THIS ILLUSTRATION WITH THE TOOL FOR FUTURE REFERENCE. IF YOU HAVE ANY QUESTIONS, CONTACT YOUR BOSTITCH REPRESENTATIVE OR DISTRIBUTOR.

ANTES DE LLEVAR A CABO CUALQUIER REPARACIÓN EN LA HERRAMIENTA, TODOS LOS OPERARIOS DEBERÁN ESTUDIAR ESTA ILUSTRACIÓN, ASÍ COMO LA LISTA DE PIEZAS Y EL MANUAL DE OPERACIÓN Y MANTENIMIENTO. LOS OPERARIOS DEBERÁN ENTENDER Y SEGUIR TODAS LAS ADVERTENCIAS E INSTRUCCIONES DE SEGURIDAD. CONSERVE ESTA ILUSTRACIÓN CON LA HERRAMIENTA PARA PODER CONSULTARLA EN LO FUTURO. SI TUVIERA ALGUNA PREGUNTA, PÓNGASE EN CONTACTO CON SU REPRESENTANTE O DISTRIBUIDOR DE BOSTITCH.

AVANT DE PROCÉDER À LA RÉPARATION DE CET OUTIL, LES OPÉRATEURS DOIVENT ÉTUDIER LA PRÉSENTE ILLUSTRATION AINSI QUE LA LISTE DE PIÈCES ET LE MANUEL D'INSTRUCTIONS ET D'ENTRETIEN ; ILS DOIVENT ÉGALEMENT COMPRENDRE ET OBSERVER LES CONSIGNES DE SÉCURITÉ ET LES INSTRUCTIONS. CONSERVER CETTE ILLUSTRATION AVEC L'OUTIL POUR RÉFÉRENCE FUTURE. SI VOUS AVEZ DES QUESTIONS, COMMUNIQUEZ AVEC VOTRE REPRÉSENTANT OU VOTRE DISTRIBUTEUR DE BOSTITCH.

IP1219-1REV G 6/07

BOSTITCH®
Stanley Fastening Systems L.P.

N89C

COIL-FED PNEUMATIC FRAMING NAILER CLAVADORA NEUMÁTICA ALIMENTADA POR ROLLO CLOUEUR PNEUMATIQUE À ENROULEMENT

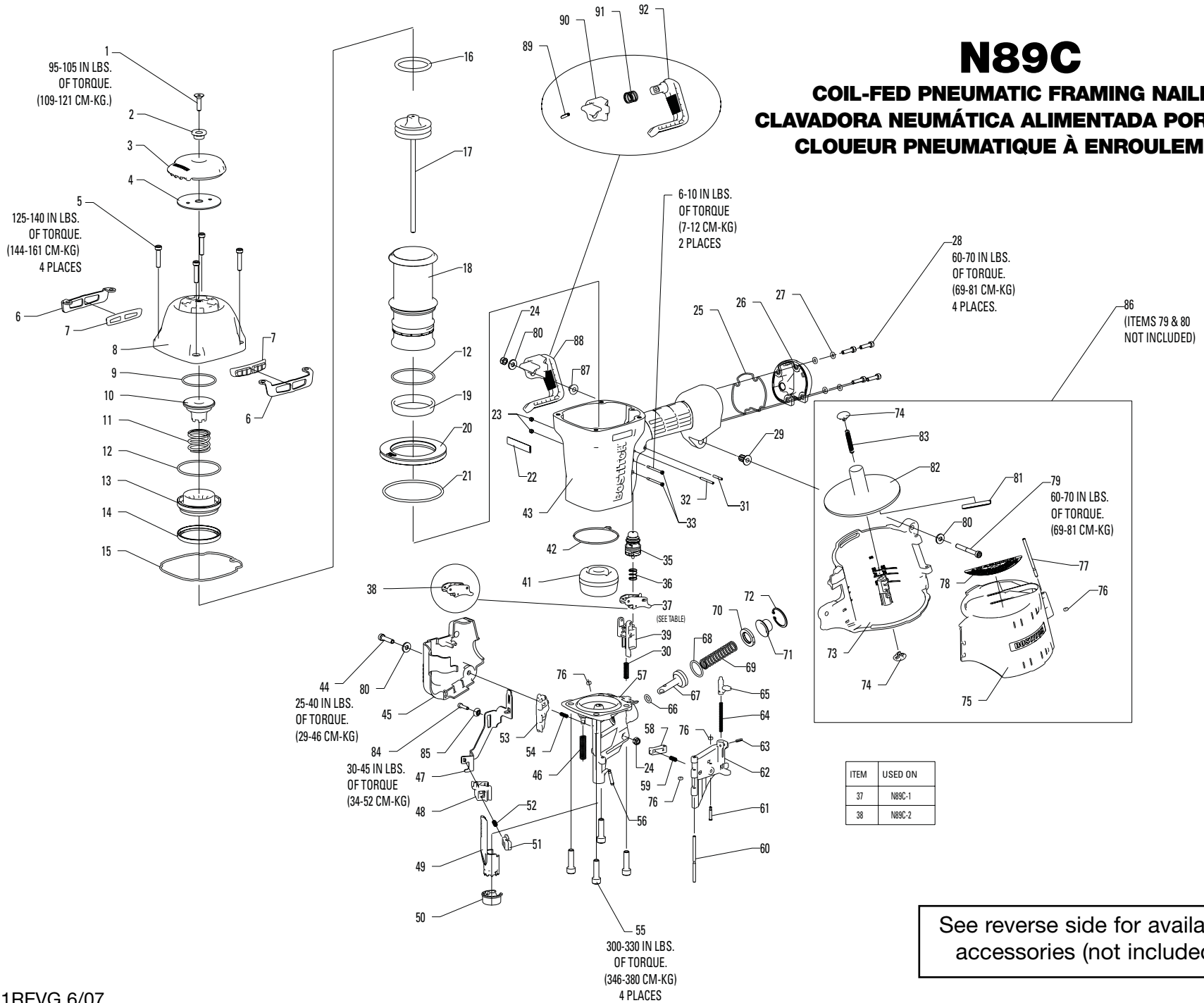

See reverse side for available accessories (not included)

BOSTITCH

N89C		Parts List:		IP1219-2REVM	
To be Used with tool parts illustration:					
				IP1219-1REVG	
and operation and maintenance manual:				166796	
Serial Number on the Tool:				N89C 8245 000 and Higher	
ITEM	PART #	DESCRIPTION	ITEM	PART #	DESCRIPTION
1	MSF6100-25	SCREW,SFHCS,M6X1.00X25	56	166787	PIN,FEED PAWL
2	163859	BUSHING,EXHAUST DEFLECTOR	57	166763	NOSE,MACHINING,N89C
3	163818	DEFLECTOR,EXHAUST	58	N70149	PAWL CHECK
4	163830	PLATE,CAP	59	854011	COMPRESSION SPRING
5	MSC6100-30	SCREW,SHCS,M6X1.00X30	60	N80125	PIN,SPECIAL
6	163827	PLATE,WEAR	61	N70140	PIN,SPECIAL(STEP)
7	149819	WEAR GUIDE	62	166760	DOOR,MACHINING,N89C
8	163848	FRAME CAP,MACHINING	63	MPG030012	PIN,SPRING,M3X12MM
9	105814	O-RING,1.929X.098	64	854013	SPRING,COMPRESSION
10	163820	BUMPER,HEAD VALVE	65	N70150	LATCH DOOR
11	163844	SPRING,HEAD VALVE	66	88999	O-RING,.362X.103
12	163822	O-RING,2.487X.103XNBR	67	163894	PISTON,FEED
13	163821	LOWER BODY,HEAD VALVE	68	87112	O-RING,.924X.103
14	163823	SEAL,HEAD VALVE	69	163930	SPRING,FEED PISTON
15	163845	SEAL,FRAME/CAP	70	163897	STOP,FEED PISTON
16	851606	O-RING,1.850X.210	71	163895	COLLAR,SPRING
17	163816	ASSEMBLY,PISTON/DRIVER	72	163896	RETAINING RING,INCH
18	163824	SLEEVE,CYLINDER	73	163892	PLATFORM,CANISTER,N89C
19	175520	SEAL,CHECK	74	149910	CAP,NAIL TRAY
20	163855	RING,CYLINDER SLEEVE	75	163910	COVER,CANISTER,N89C
21	108718	O-RING,3.484X.139	76	854004	WASHER,RUBBER-7
22	163881	LABEL,N89C	77	166771	PIN,CANISTER COVER
23	MHE3050-100	NUT,NYLON M3X.50	78	165358	LABEL,WARNING,PALLET
24	MHE6100-100	NUT,ESN M6X1	79	MSC6100-50	SCREW,SHSC,M6X1.00X50
25	163856	SEAL,END CAP	80	MPW6.2	WASHER,SPECIAL
26	163843	END CAP,PAINT	81	120927	LABEL,SENSOR SMALL (DR)
27	T50118	WASHER,PLAIN	82	180545	OVERMOLD,TRAY
28	MSC5080-20	SCREW,SOC HD. CAP M5 X 20	83	166768	SPRING,EXTENSION - CANISTER
29	123859	BUSHING,FLANGED ISOLATION	84	MSC4070-16	SCREW,SHCS,M4X0.7X16
30	166781	SPRING,UPPER TRIP	85	163876	BUSHING,UPPER CONTACT ARM
31	MPP030020	PIN,SPIRAL M3X20MM	86	166807	ASSEMBLY,CANISTER
32	100298	PIN,SPIRAL M3X30	87	171342	WASHER,UTILITY HOOK
33	108562	SCREW,TRIGGER PIVOT	88	171354	ASSEMBLY,UTILITY HOOK
35	TVA6	KIT,TRIGGER VALVE	89	UB3811.2	PIN, SPIROL - 5/32X3/4
36	100387	SPRING,COMPRESSION	90	171340	MOUNT,UTILITY HOOK
37	CNTK5	KIT,CONTACT TRIP CONVERSION	91	171341	SPRING,UTILITY HOOK
38	SEQ7	KIT,SEQUENTIAL TRIP CONVERSION	92	171339	HOOK,UTILITY
39	163883	GUIDE,ARM			
41	107231	BUMPER,DRIVE			
42	163884	SEAL,NOSE			
43	171127	FRAME,OVERMOLD			
44	MSC6100-25	SCREW,SHCS,M6X1.00X25			
45	166766	COVER,TRIP			
46	116970	SPRING,CONTACT ARM			
47	163908	ARM,UPPER CONTACT			
48	163906	CASTING,HOUSING CONTACT			
49	163907	ARM,LOWER CONTACT			
50	166765	FOOT,TRIP,N89C			
51	108225	CASTING,PLUNGER			
52	115230	SPRING,HOUSING			
53	166773	PAWL,FEED,MACHINING,N89C			
54	166774	SPRING,FEED PAWL			
55	MSC8125-30	SCREW,SHCS M8X30			